

Gateway

USER MANUAL

GWAP42424

Start Here

1

Slide stand arm onto stand base

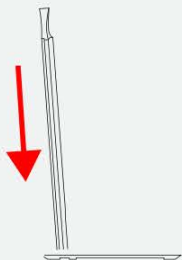

2

Tighten screw on the bottom of base into stand until fastened

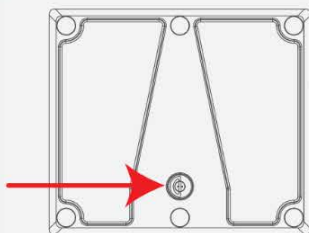

3

Line up on the four holes on the stand VESA panel with the holes backside of the monitor

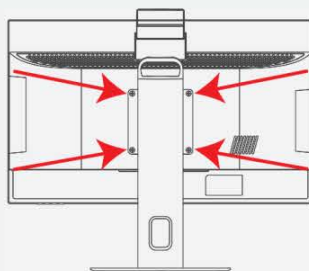

4

Fasten four screws (phillips screwdriver needed)

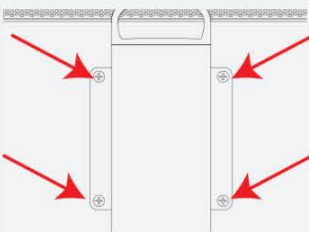

5

Plug Power Adapter Into Wall Outlet

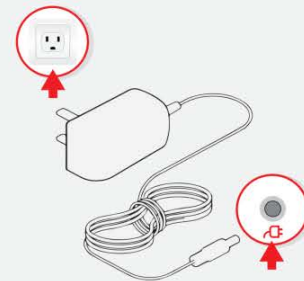

6

Plug Power Adapter Into Laptop



7

Press and Release the Power button



8

Follow the on screen Windows prompts to finish setting up

Caution: The AC adapter included with your PC was specifically designed and approved for your model. Utilization of an after-market adapter may damage either the notebook or other devices connected to it. If damage is determined to have been caused by utilization of an unauthorized power supply, it will not be protected under warranty. For support, please visit <https://www.gatewayusa.com/support.html>.

Gateway and the Gateway logo are the registered trademarks of Acer Inc, and are used license from Acer America Corporation.

www.gatewayusa.com | Customer Service: (877) 777-0649

Exterior Features

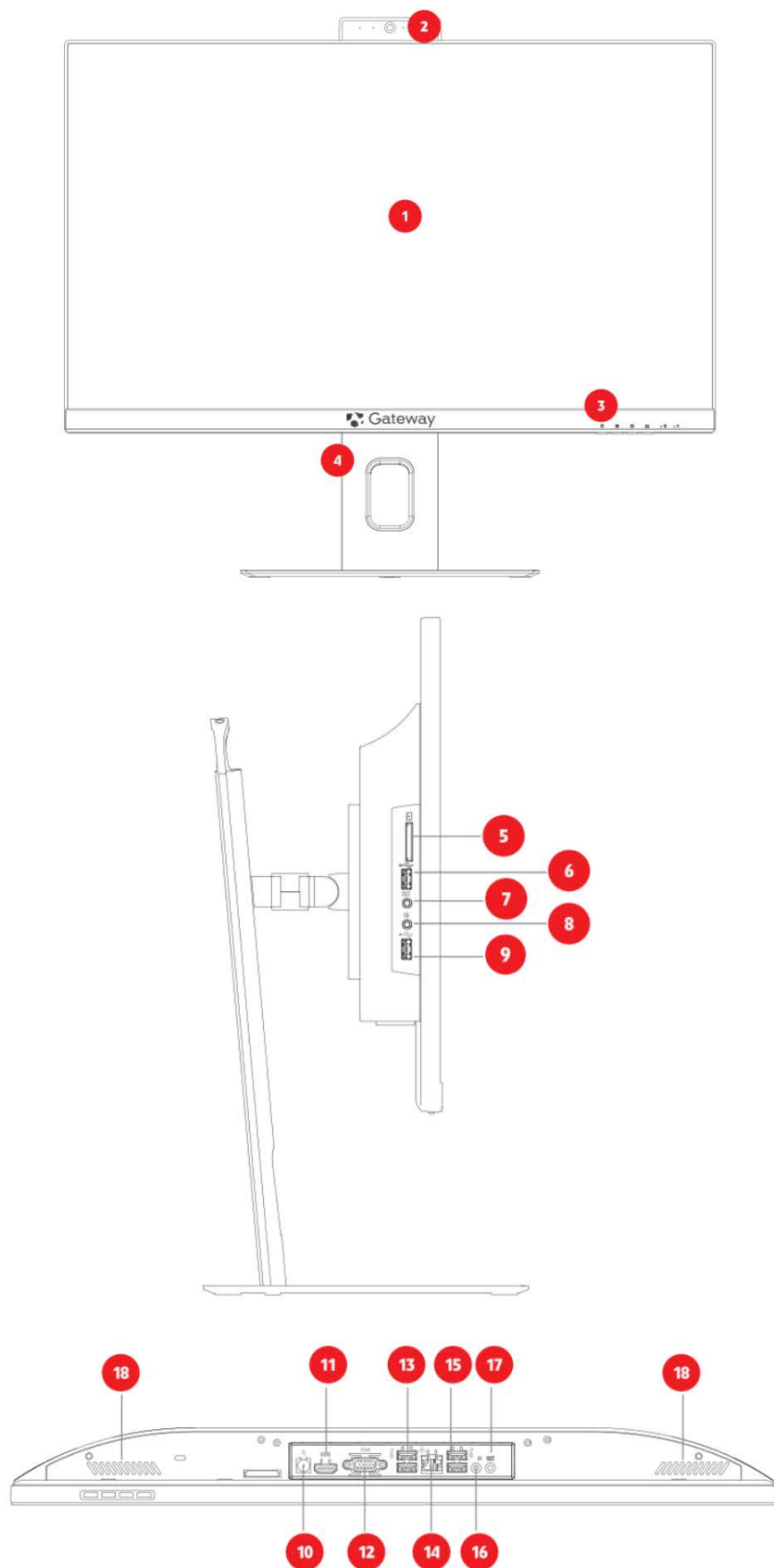

- 1 Monitor screen
- 2 Pop-up Camera
- 3 Power On/Off
- 4 Fully Adjustable Stand
- 5 SD Card Slot
- 6 USB 2.0
- 7 Audio Out/Headset
- 8 Mic In
- 9 USB 2.0
- 10 Power Adapter Port
- 11 HDMI
- 12 VGA
- 13 USB 3.0 X 2
- 14 Ethernet Port
- 15 USB 3.0 X2
- 16 Mic In
- 17 Audio Out/Headset
- 18 Speaker

What's in the box

- | | |
|--------------------|---------------------|
| 1 All in one PC | 4 Warranty Book |
| 2 Power Adapter | 5 Keyboard & Mouse |
| 3 Adjustable stand | 6 4 Phillips Screws |

Keyboard & Mouse

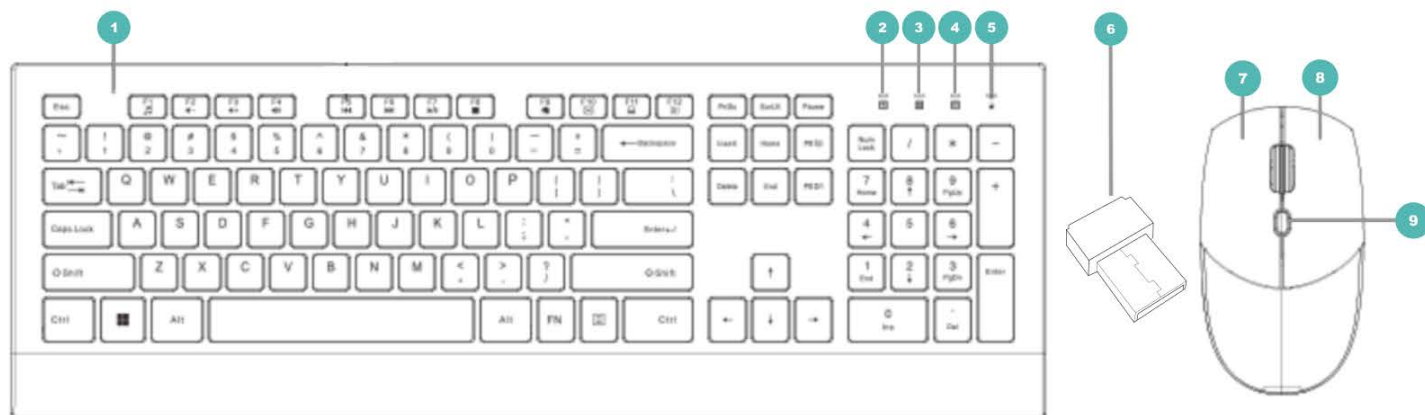

1 Chassis

The housing which holds the components together.

2 Num Lock Indicator LED

LED used to indicate whether the numeric keys are locked or unlocked.

3 Caps Lock Indicator LED

LED used to indicate whether the caps lock is enabled or disabled.

4 Scroll Lock Indicator LED

LED used to indicate whether the scroll lock is enabled or disabled.

5 Low Battery Indicator LED

LED used to indicate that the keyboard's battery is low.

6 Wireless Receiver (located inside the mouse)

A dongle used to wirelessly connect the mouse & keyboard to the computer.

7 Primary Mouse Button

The main mouse button used to navigate the computer.

8 Secondary Mouse Button

Secondary mouse button used for alternative functions.

9 DPI Button

Changes your mouse's sensitivity speed.

Notice

The information in this user's manual is protected by copyright laws, all parts of this manual, including the products and software described in it, can not be reproduced, transmitted, transcribed, stored in a retrieval system, nor translated into any language.

THE MANUFACTURER OR RESELLER SHALL NOT BE LIABLE FOR ERRORS OR OMISSIONS CONTAINED IN THIS MANUAL AND SHALL NOT BE LIABLE FOR ANY CONSEQUENTIAL DAMAGES, WHICH MAY RESULT FROM THE PERFORMANCE OR USE OF THIS MANUAL.

The illustrations in this user's manual are for reference only. Actual product specifications may vary with territories.

The information in this user's manual is subject to change without notice.

TABLE OF CONTENTS

Star Here	2
Exterior Features	3
Keyboard & Mouse	4
Notice	5
Chapter 1: Preface	7
1.1 Regulations Information	8
FCC Information	9
RF Exposure Information (SAR)	10
1.2 Safety Instructions	11
1.3 Conventions for this Manual	12
Chapter 2: Getting to know the basics	13
2.1 Product Specification	14
2.2 Preparing your Computer	16
2.3 Product Overview	17
Chapter 3: Getting started	20
3.1 AC Adapter	21
3.2 knowing the keyboard	22
3.3 Getting to know the Mouse	23
3.4 Function Keys	24

Chapter 1

Preface

1.1 Regulations Information

* CE compliance

This device is classed as technical information equipment (ITE) in class B and is intended for living room and office use. The CE-mark approves the conformity by the EU-guidelines:

- EMC Directive 2014/30/EU,
- Low Voltage Directive 2014/35/EU(equals A2 : 2013) ,
- RF Directive 2014/53/EU



Rechargeable Battery Notice

Do not

- 1.Throw into fire or a hot oven, or mechanically crush or cutting of a BATTERY
- 2.Throw or immerse into water
- 3.Heat to more than 60°C
- 4.Repaire or disassemble
- 5.Leave in an extremely low air pressure environment
- 6.Leave in an extremely high-temperature environment

A power cord is connected to a socket-outlet with earthing connection.



The unit can be operated at an ambient temperature of max. 35°C (95°F).
Do not subject it to temperatures below 5°C (41°F) or above 40°C (104 °F).

CAUTION: RISK OF EXPLOSION IF BATTERY IS REPLACED BY AN INCORRECT TYPE
DISPOSE OF USED BATTERIES ACCORDING TO THE INSTRUCTIONS.



PREVENTION OF HEARING LOSS

CAUTION: Listening to music at high volume levels and for extended durations can damage one's hearing. In order to reduce the risk of damage to hearing, one should lower the volume to a safe, comfortable level, and reduce the amount of time listening at high levels. Headsets should comply with EN 50332-2 requirements.



FCC Information

FEDERAL COMMUNICATIONS COMMISSION INTERFERENCE STATEMENT

This equipment has been tested and found to comply with the limits for a Class B digital device, pursuant to part 15 of the FCC Rules. These limits are designed to provide reasonable protection against harmful interference in a residential installation. This equipment generates, uses and can radiate radio frequency energy and, if not installed and used in accordance with the instructions, may cause harmful interference to radio communications. However, there is no guarantee that interference will not occur in a particular installation. If this equipment does cause harmful interference to radio or television reception, which can be determined by turning the equipment off and on, the user is encouraged to try to correct the interference by one or more of the following measures:

- Reorient or relocate the receiving antenna.
- Increase the separation between the equipment and receiver.
- Connect the equipment into an outlet on a circuit different from that to which the receiver is connected.
- Consult the dealer or an experienced radio/ TV technician for help.



CAUTION: Any changes or modifications not expressly approved by the grantee of this device could void the user's authority to operate the equipment.

RF Exposure Information(SAR)

This device meets the government's requirements for exposure to radio waves. This device is designed and manufactured not to exceed the emission limits for exposure to radio frequency (RF) energy set by the Federal Communications Commission of the U.S. Government.

The exposure standard employs a unit of measurement known as the Specific Absorption Rate, or SAR. The SAR limit set by the FCC is 1.6 W/kg. Tests for SAR are conducted using standard operating positions accepted by the FCC with the EUT transmitting at the specified power level in different channels.

The FCC has granted an Equipment Authorization for this device with all reported SAR levels evaluated as in compliance with the FCC RF exposure guidelines. SAR information on this device is on file with the FCC and can be found under the Display Grant section of www.fcc.gov/eot/ea/fccid after searching on FCC ID: 2AKHFAX200NG.

This device complies with Part 15 of the FCC Rules.

Operation is subject to the following two conditions:

- (1) this device may not cause harmful interference, and
- (2) this device must accept any interference received, including interference that may cause undesired operation.



CAUTION: Any changes or modifications not expressly approved by the grantee of this device could void the user's authority to operate the equipment.

1.2 Safety Instructions



- 01 Do not apply heavy pressure to the computer or subject it to any form of strong impact as this can damage the computer's components or otherwise cause it to malfunction.
- 02 Never cover or block the air vents including those located at the base of the computer. Never cover your computer or AC adapter with any object.
- 03 To keep your computer in prime operating condition, protect your work area from direct sunlight.
- 04 Do NOT expose to or use near liquid, rain, or moisture.
Do NOT use the modem during electrical storms.
- 05 Do not use or expose this device around magnetic fields as magnetic interference may affect the performance of the device.

1.3 Conventions for this Manual



CAUTION: This message contains important information that must be followed for safe operation.



NOTE: This message contains information for special situations.

1.3 Conventions for this Manual

Date	Version	Revision
02/2022	1.0	Initial release

Chapter 2

Getting to know the basics

2.1 Product Specification

This User's Manual provides technical information of instructions and illustrations on how to operate this notebook for the customer. Please read this manual carefully before using this computer.

PHYSICAL CHARACTERISTIC

•Dimension

L 21.2" x W 12.8" x H 2.1"

CPU

•Support Processor

Manufacturer: Intel

Processor name: Pentium Silver J5040

Core name: Gemini Lake Refresh

Generation: 3rd

Architecture: x86

Cores: 4

Threads: 4

Frequency: 2.0 GHz

Turbo frequency: 3.2GHz

Thermal Design Power (TDP): 10W

GPU

•Graphics Card

Integrated

MEMORY

•RAM

Built in 4GB DDR4

DISPLAY

•LCD

Screen size: 23.8"

Panel type: IPS - FULL HD anti-glare (non-touch)

NITS: 200-250

I/O PORTS

DC-in.....	x 1
HDMI.....	x 1
VGA.....	x 1
USB 3.0.....	x 4
USB 2.0.....	x 2
Ethernet Port.....	x 1
Mic In.....	x 2
Audio Out/Headset.....	x 2
SD Card Slot.....	x 1

AUDIO

• Audio Codec ALC269

•Speaker/MIC

*Built-in dual speakers

*Digital Microphone support

INPUT

•Keyboard

Standard

US/UK plate

COMMUNICATION PORT

•Wireless LAN

* Intel 7265

WEBCAM

•HD Webcam

2 MP/Top w/LED

POWER

•AC Adapter

60W, 12V 5A 3.5mm



CAUTION: MODEL IS DESIGNED TO BE USED WITH THE
DC INPUT: (60W, 12V 5A 3.5mm)

2.2 Preparing your Computer

- 1** Slide stand arm onto stand base

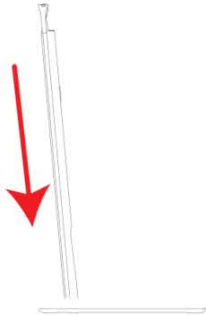

- 2** Tighten screw on the bottom of base into stand until fastened

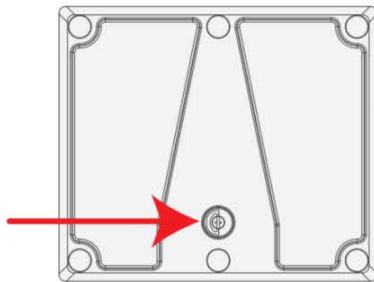

- 3** Line up the four holes on stand VESA panel with the holes on the backside of the monitor

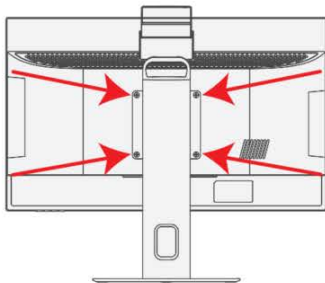

- 4** Fasten four screws (phillips screwdriver needed)

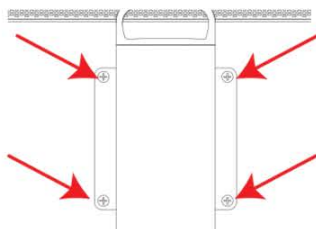

- 5** Plug power adapter into wall outlet

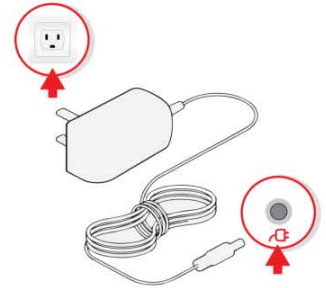

- 6** Plug power adapter into All-in-one PC



- 7** Press the power button to power on All-in-one PC

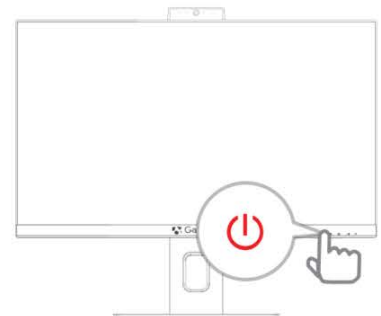

- 8** Follow the on screen Windows prompts to finish setting up

2.3 Product Overview

Please become familiar with each component before you operate the computer.

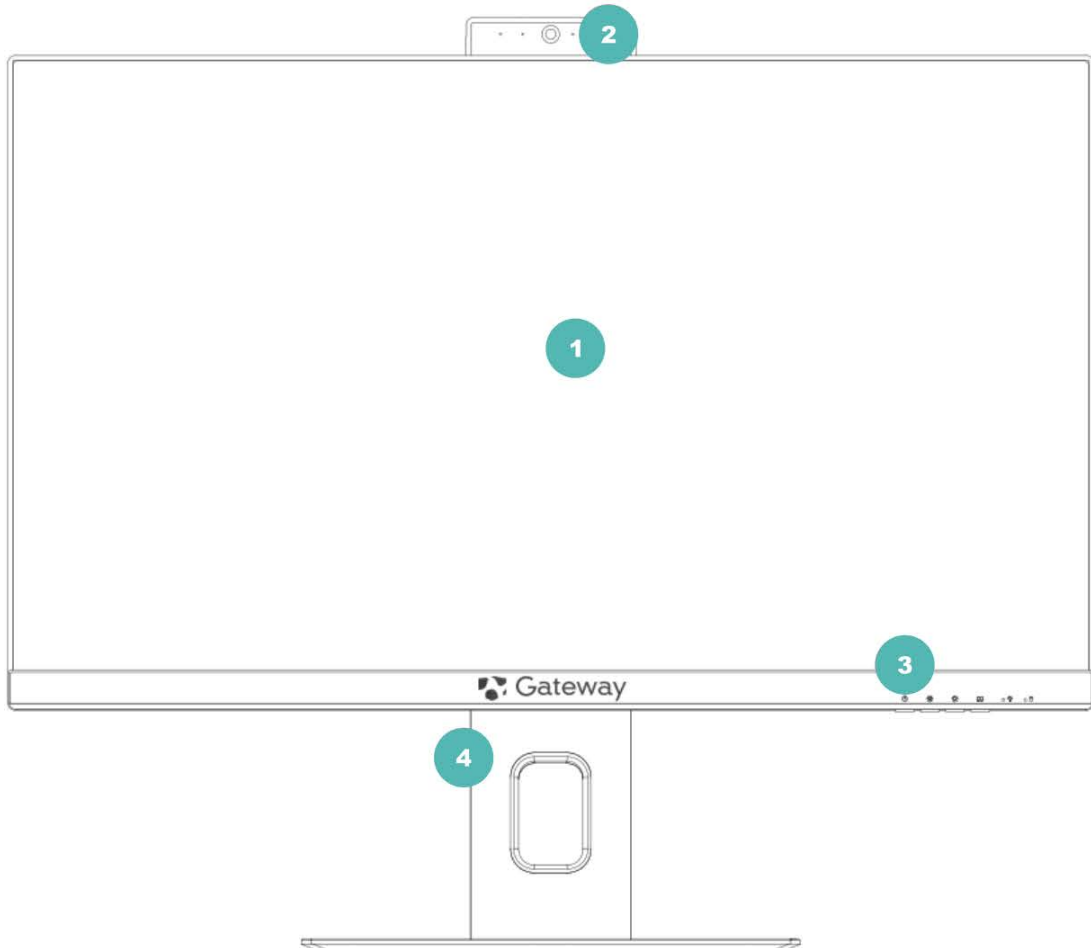

1 Monitor screen

An LCD screen to displays the graphic user interface.

2 Pop-up Camera

A built in web camera that can be hidden when not in use.

3 Power On/Off

Button used to power on and off the computer.

4 Fully Adjustable Stand

Aluminum computer stand used to mount the monitor, which allows the user to adjust height and angle.

Side View

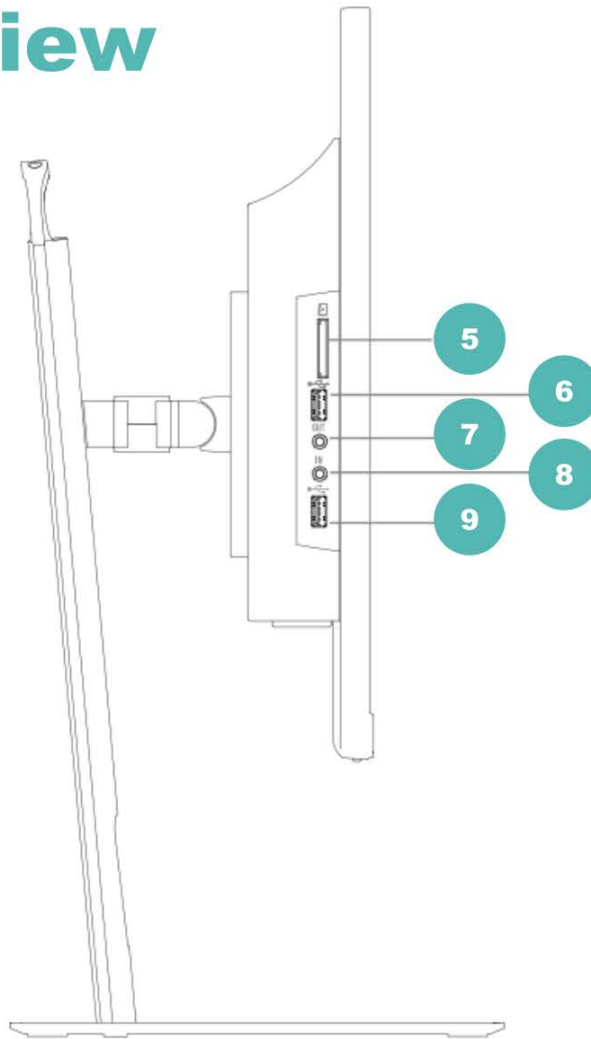

5 SD Card Slot
Slot made for installing an SD card to increase storage.

6 USB 2.0
Universal serial bus port used for connecting devices via USB and data transferring.

7 Audio Out/Headset
Used to connect headphones or earphones.

8 Mic In
Use to connect a microphone

9 USB 2.0
Universal serial bus port used for connecting devices via USB and data transferring.

Bottom Side View

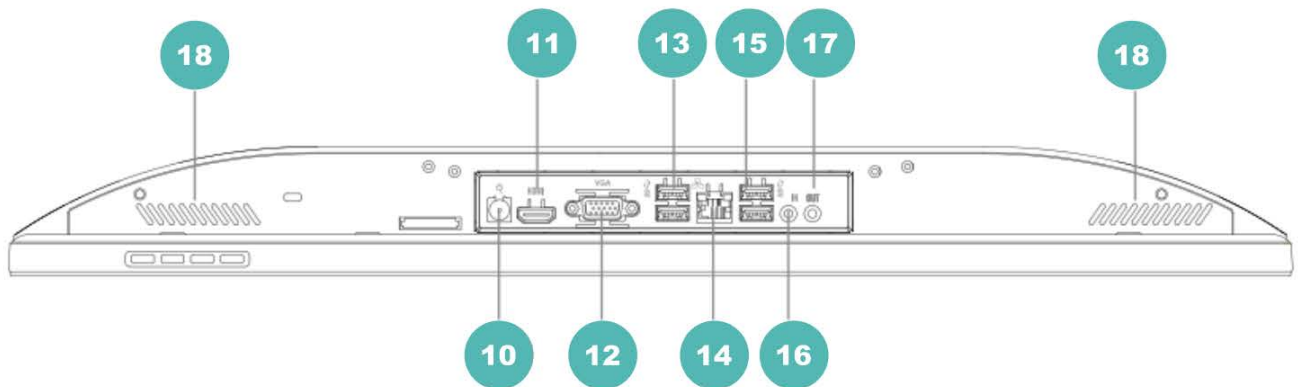

10 **Power Adapter Port**

Used to connect the power adapter..

11 **HDMI**

High-Definition Multimedia Interface port used for high definition audio and video.

12 **VGA**

Video graphics array port used for connecting another monitor.

13 **USB 3.0 port**

Universal serial bus port used for connecting devices via USB and data transferring.

14 **Ethernet port**

RJ-45 port used for connecting internet directly.

15 **USB 3.0 port**

Universal serial bus port used for connecting devices via USB and data transferring.

16 **Mic In**

Used to connect a microphone.

17 **Audio Out/Headset**

Used to connect headphones.

18 **Speaker**

High-Definition Multimedia Interface port used for high definition audio and video.

Chapter 3

Getting started

3.1 AC Adapter

Plug in the power adapter to power on your computer.

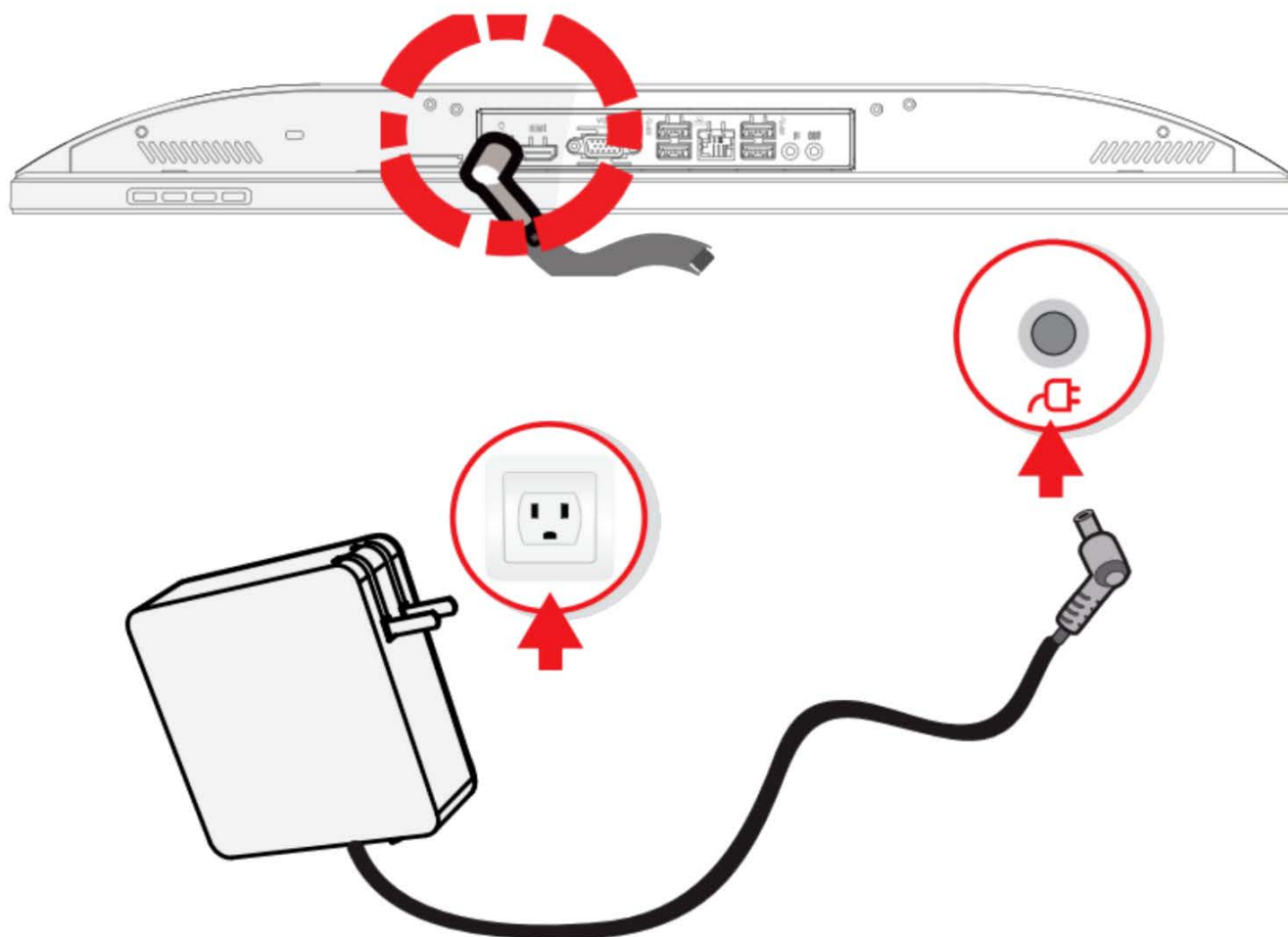

CAUTION: The use of inferior extension cords may result in damage to your notebook. Your computer comes with its own authorized AC adapter. Use of a different AC adapter or cable extension which is not authorized for use will void warranty protection if damage to hardware is found in association to said adapter or extension cable.



NOTE: The power adapter can become hot when in use. Please be sure the AC adapter is not covered with any materials keep it away from exposed parts of your body. The AC adapter appearance may vary depending on your region.

3.2 Knowing the Keyboard



1 Chassis

The housing which holds the components together.

2 Num Lock Indicator LED

LED used to indicate whether the numeric keys are locked or unlocked.

3 Caps Lock Indicator LED

LED used to indicate whether the caps lock is enabled or disabled.

4 Scroll Lock Indicator LED

LED used to indicate whether the scroll lock is enabled or disabled.

5 Low Battery Indicator LED

LED used to indicate that the keyboard's battery is low.







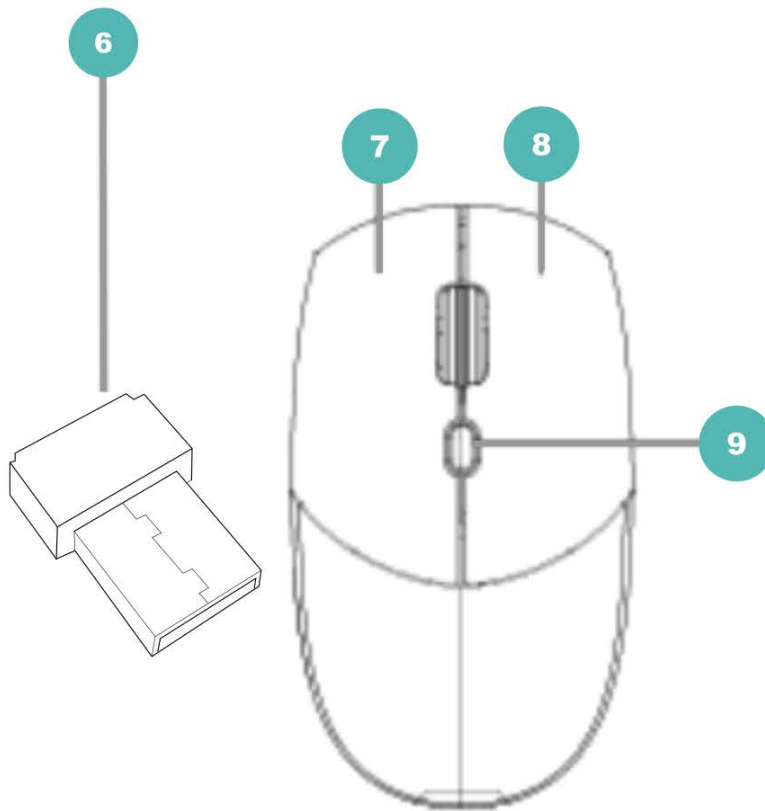





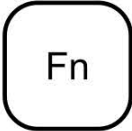

NOTE: The number of keys available on your keyboard will depend on the country/region in which the keyboard was designed and built.

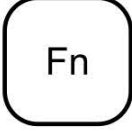
3.2 Knowing the Mouse

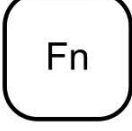

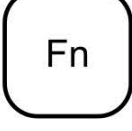

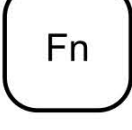





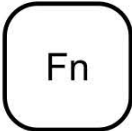

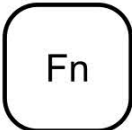

- 6 Wireless Receiver (located inside the mouse)**
A dongle used to wirelessly connect the mouse & keyboard to the computer.
- 7 Primary Mouse Button**
The main mouse button used to navigate the computer.
- 8 Secondary Mouse Button**
Secondary mouse button used for alternative functions.
- 9 DPI Button**
Changes your mouse's sensitivity speed.

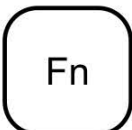
Function Keys

Keypad Combination	Function Description
 +  Open Windows Media Player:	Press this key combination (Fn + F1) to launch Windows Media Player.
 +  Volume Down:	Press this key combination (Fn + F2) to lower the computer's volume.
 +  Volume Up:	Press this key combination (Fn + F3) to increase the computer's volume.
 +  Mute Volume:	Press this key combination (Fn + F4) to mute the computer's audio.
 +  Skip Foward:	Press this key combination (Fn + F5) to skip videos foward.
 +  Skip Backward:	Press this key combination (Fn + F6) to skip videos backward.

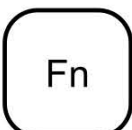
Function Keys

Keypad Combination	Function Description
 +  Play/Pause:	Press this key combination (Fn + F7) to launch Windows Media Player.
 +  Stop:	Press this key combination (Fn + F8) to lower the computer's volume.
 +  Home:	Press this key combination (Fn + F9) to open up internet explorer.
 +  Email:	Press this key combination (Fn + F10) to open your email.
 +  Skip Foward:	Press this key combination (Fn + F11) to open Windows file explorer.
 +  Customizable key:	This key combination (Fn + F12) can be set to a custom function.